

oakfull 澳可富

OAKFULL Pre-filter

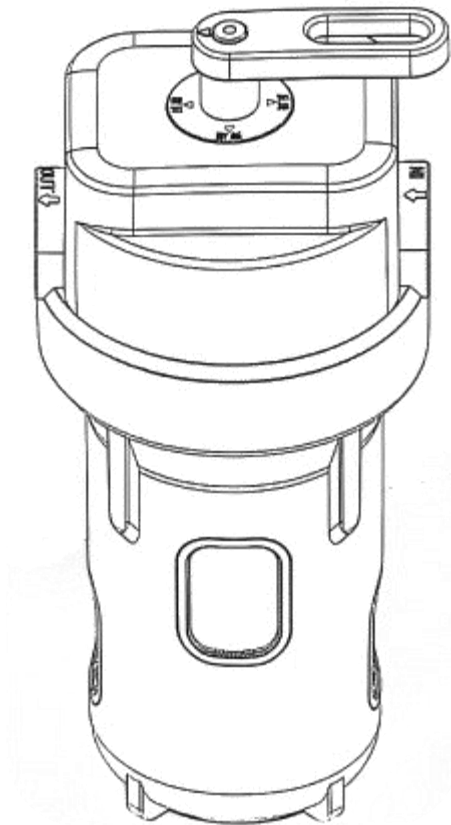

Please read the instruction manual carefully and keep it in a safe place.

Preface

Thank you for purchasing this pre-filter! The product manual contains important information regarding the installation, operation, and maintenance of this unit. Please read the instruction manual carefully and keep it in a safe place.

Please read before installing the pre-filter:

- Packaging materials may be dangerous to children. Please keep packaging materials (such as plastic bags) out of the reach of children.
- Read the contents of this manual carefully and ensure that this pre-filter is installed by qualified professionals.

Functions and Benefits:

- Made of high-quality, food-grade materials;
- Multiple filter cartridge options, with high flow rate for whole-house water purification;
- Comes standard with a filter spanner wrench for quick and easy installation;
- Features filtration mode, bypass mode, backwash mode, shut-off mode, and a pressure relief button;
- Operates using municipal water pressure, no electricity required, energy-saving and environmentally friendly;
- Dual outlet structure;
- Viewing window.

Table of Contents

Precautions	1
Product Introduction	2
1.Appearance Features	2
2.Technical Specifications.....	2
3.Working Principle Diagram	3
4.Functions and Features	3
Installation Instructions	4
1.Package Contents	4
2.Installation Precautions	4
3.Installation Steps	6
4.Overall Installation Diagram	10
5.Filter Cartridge Replacement.....	11
Warranty Information.....	13

Precautions

- The filtered water from this product is not drinkable;
- Please have it installed by a professional. Close the water supply valve before installation;
- If the pre-filter is installed indoors and the temperature drops below 5°C, anti-freeze measures must be taken;
- If the pre-filter is installed outdoors and the temperature drops below 5°C, or if it will not be used for an extended period, close the inlet ball valve, drain all water from the pre-filter, and stop using it;
- Do not place the pre-filter in direct sunlight;
- Keep the "filtered water" outlet clean;
- Filtered water should be used promptly and not stored;
- The frequency of filter cartridge replacement varies depending on water usage, water quality, and water pressure;
- If the unit has not been used for more than two weeks, turn the control valve handle to the backwash position, wait 5 minutes for flushing, then turn the handle to the filtration position before use;
- During maintenance, do not use soap, detergents, thinners, alcohol, etc;
- Do not use the pre-filter with the filter cartridge removed;
- Do not disassemble the filter cartridge while the pre-filter is in use;
- If leakage occurs, close the water supply valve and tighten all connection seals. If water leaks from the filter housing, tighten the filter housing;
- The inlet water temperature for this pre-filter must not exceed 38°C;
- The operating ambient temperature for this pre-filter is 5~40°C;
- Do not block the filtered water outlet or connect it to other devices;
- If the water pressure exceeds 0.45MPa, install a pressure reducing valve;
- Do not use this pre-filter near high-temperature appliances or open flames³.

Product Introduction

1. Appearance Features

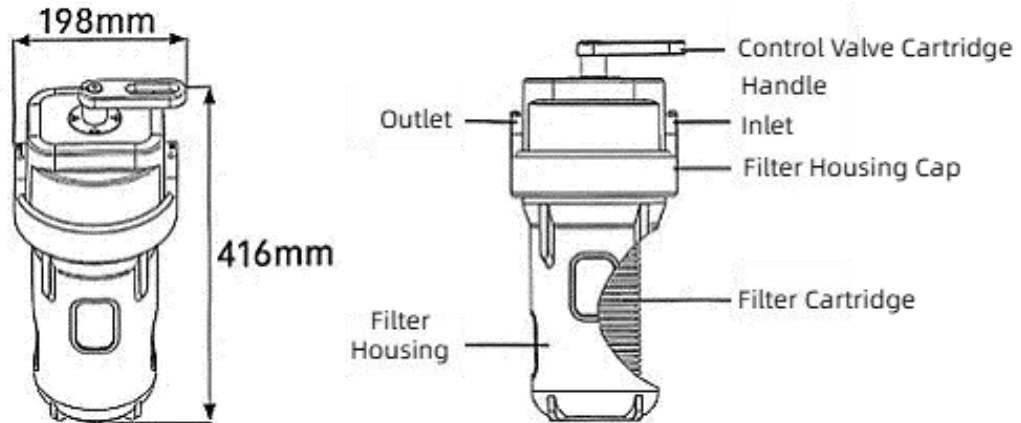

2. Technical Specifications

Product Model	Pre-filter
Ambient Humidity	≤90%
Ambient Temperature	5~40°C
Applicable Water Quality	Municipal Tap Water
Applicable Water Pressure	0.15~0.45MPa
Applicable Water Temperature	5~38°C
Flow Rate	3000L/h
Normal Operating Flow Rate	4000L/h
Total Filtered Water Capacity	30m ³
Compatible Filter Cartridge	PP filter cartridge (optional)
Applicable Standard	GB/T30307
Recommended Replacement Interval	3-6 months (actual interval depends on total water consumption)

Product Introduction

3. Working Principle Diagram

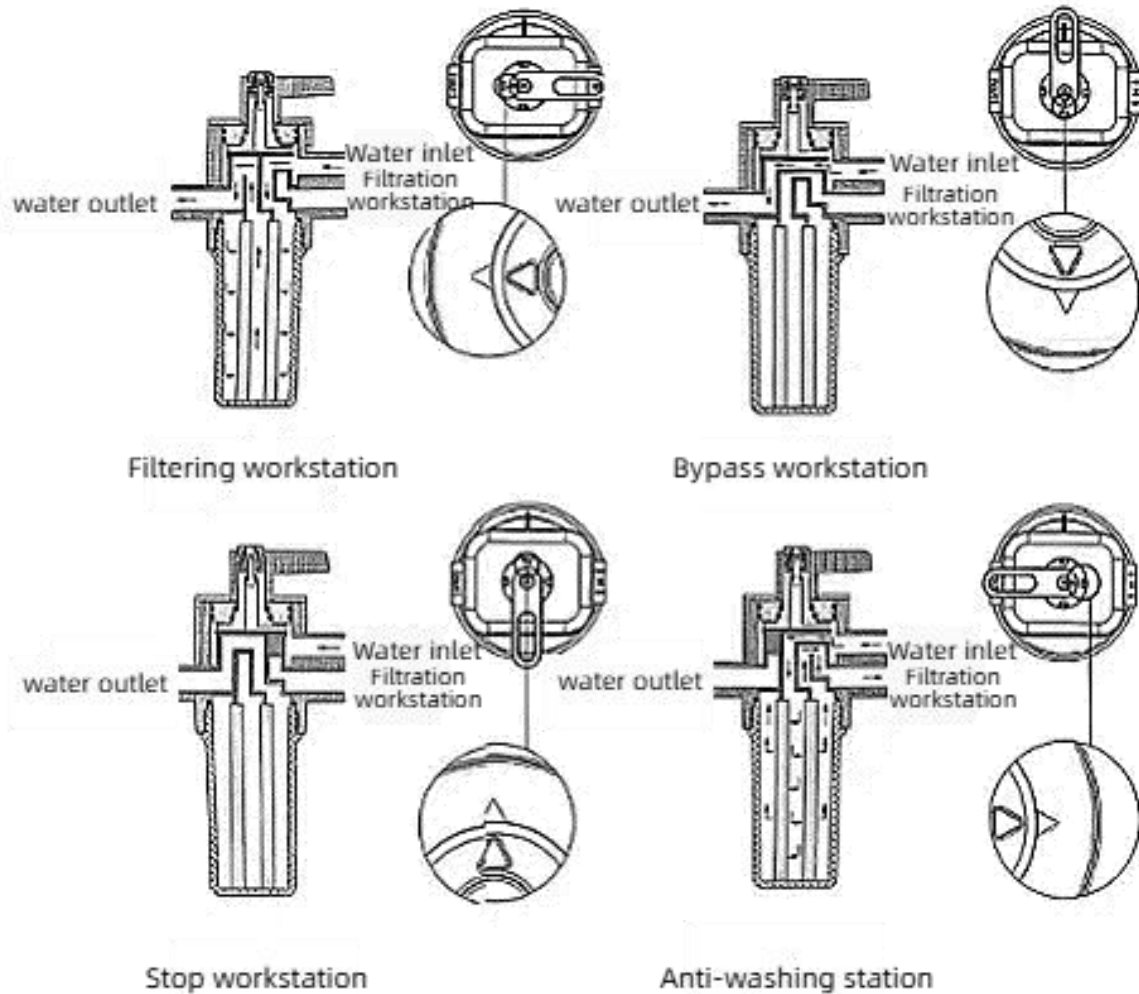

4. Functions and Features

(1) Filtration Mode:

Raw water flows through the pre-filter at a certain pressure and flow rate. The purification filter cartridge effectively removes chlorine, rust, algae, and suspended solids from the water, leaving the treated water clean and clear.

(2) Bypass Mode:

In the event of a pre-filter malfunction, filter cartridge replacement, or other special circumstances, turn the control valve handle to the bypass mode. You can temporarily use the municipal water supply directly. After the issue is resolved or the filter cartridge is replaced, turn the control valve handle back to the filtration mode to resume filtered water supply.

(3) Shut-off Mode:

In case of community water outages, pre-filter malfunction, or other special circumstances, turn the control valve handle to the shut-off mode. The pre-filter will stop water supply. After the issue is resolved, turn the control valve handle back to the filtration mode to resume filtered water supply.

(4) Backwash Mode:

Under the action of backwashing water flow, colloids and retained debris on the filter cartridge surface are flushed away. This prevents bacterial growth and secondary contamination, allowing the filter cartridge to partially recover its filtration capacity.

Installation Instructions

1. Package Contents

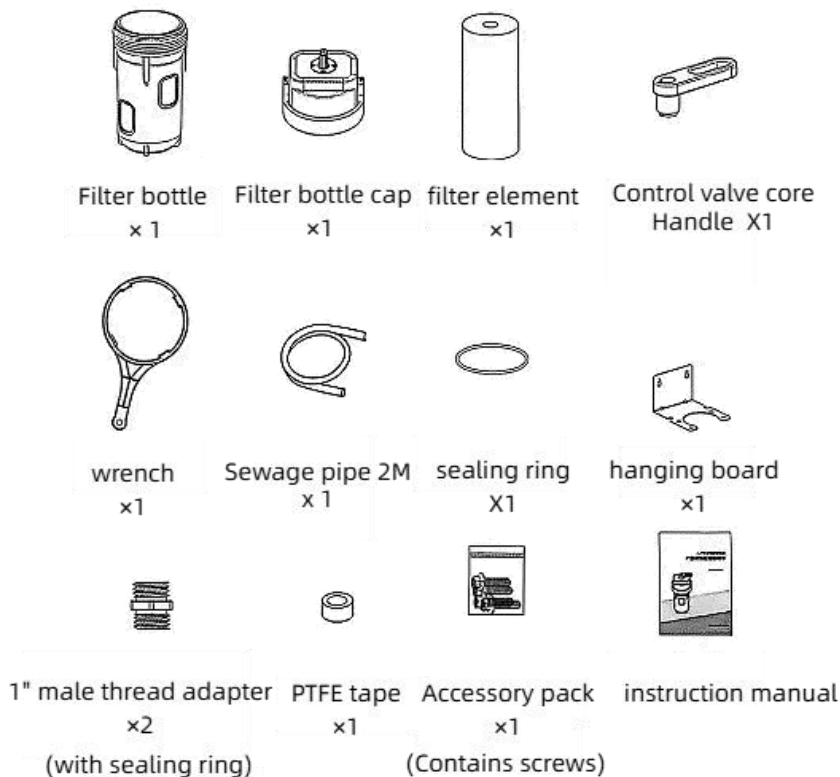

2. Installation Precautions

- Read and follow this manual before installing and using the pre-filter.
- The piping installation of the pre-filter must comply with relevant plumbing construction standards.
- The operating water pressure of the pre-filter is 0.15–0.45 MPa. If the water pressure is lower than the specified operating pressure of the pre-filter, install a booster pump upstream of the pre-filter inlet. If the water pressure is higher than the specified operating pressure, install a pressure reducing valve upstream of the pre-filter inlet.
- During a community water outage, immediately close the main water supply valve or turn the pre-filter to the shut-off mode to prevent damage caused by negative pressure in the pipes due to the municipal water outage.
- When community water supply is restored, first turn the pre-filter to the bypass mode, open a faucet in your home, and let the contaminated water from the supply pipes run out. Once the water runs clear, switch

from bypass mode to filtration mode. This is because a large amount of contaminants in the tap water mains can pollute the pre-filter when supply is restored.

Installation Instructions

- Avoid installing the pre-filter in locations subject to water hammer. If water hammer is present, a water hammer arrester must be installed upstream of the pre-filter.
- The pre-filter must be installed in accordance with the marked inlet and outlet directions. The pre-filter must be installed and used in a room with a floor drain that has unobstructed drainage. In the event of a drainpipe or floor drain blockage, immediately close the building's main water supply valve. The company is not responsible for losses caused by drainage issues.
- As shown in the figure below, the drain hose must be secured to the wall with a ring clamp to prevent it from being dislodged during drainage.
- The drain hose must be the one supplied with the product. Do not extend the hose length or reduce its diameter.
- When connecting the pipes, pay attention to the height and positioning angle. After connection, there must be no significant stress on the pipes, as stress over long-term use could cause pipe damage and lead to leakage from the pre-filter connections.
- Do not use the pre-filter if the drain hose or floor drain is blocked. The drainage must be unobstructed. An air gap must be maintained between the drain hose and the wastewater to prevent vacuum negative pressure from causing the pre-filter to malfunction or allowing wastewater to backflow into the pre-filter.

Installation Instructions

3. Installation Steps



Depending on the mounting position of the hanging plate, the top cover can be repositioned to the opposite side as needed.

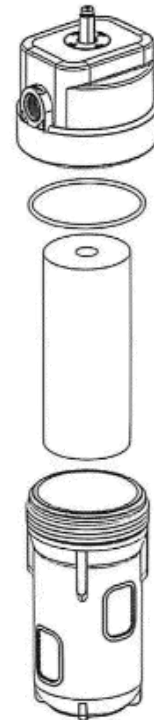

1. Remove the front cover. The top cover can then be installed in the opposite direction.

2. Unscrew the filter housing, remove the plastic sealing film from the filter cartridge, fit the O-ring onto the filter housing, and tighten the filter housing using a wrench.

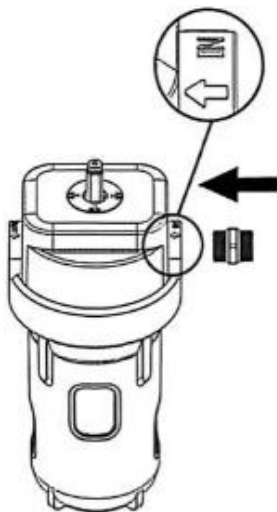

3. Wrap the 1-inch male threaded connector with PTFE tape, then connect it to the water inlet;

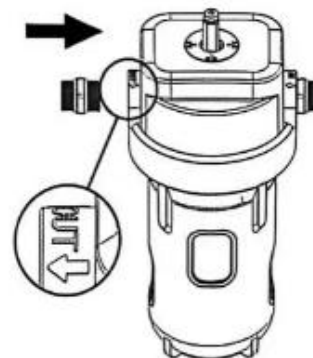

4. Wrap the 1-inch male threaded connector with PTFE tape, then connect it to the water inlet;

Installation Instructions

For left inlet and right outlet configuration

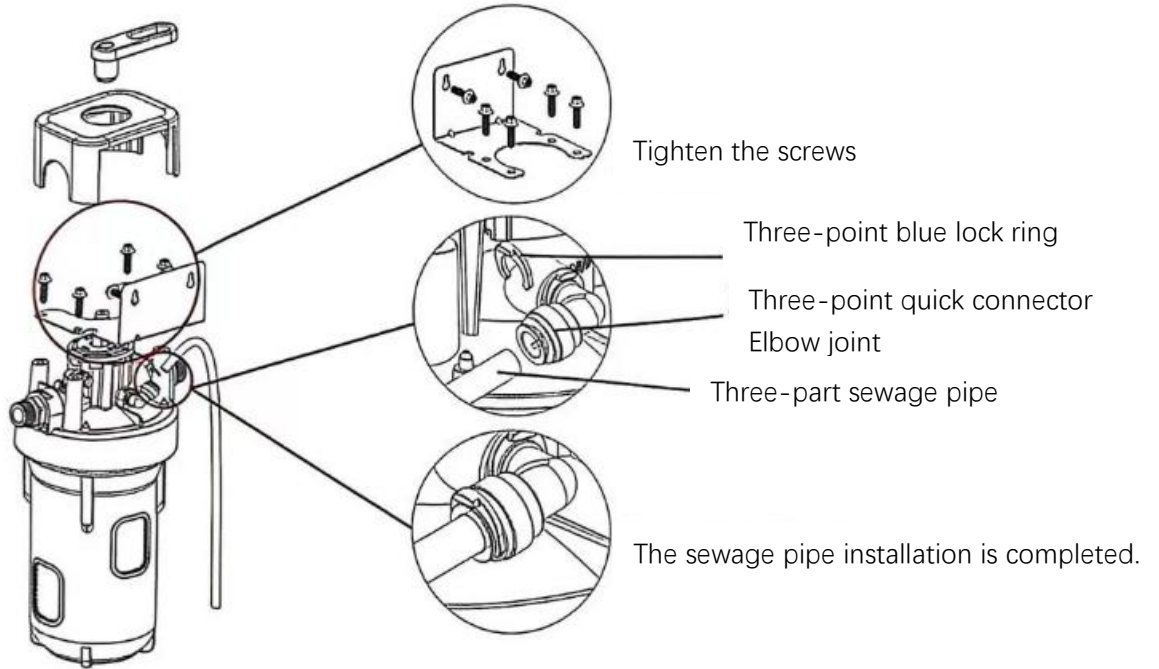

For right inlet and left outlet configuration

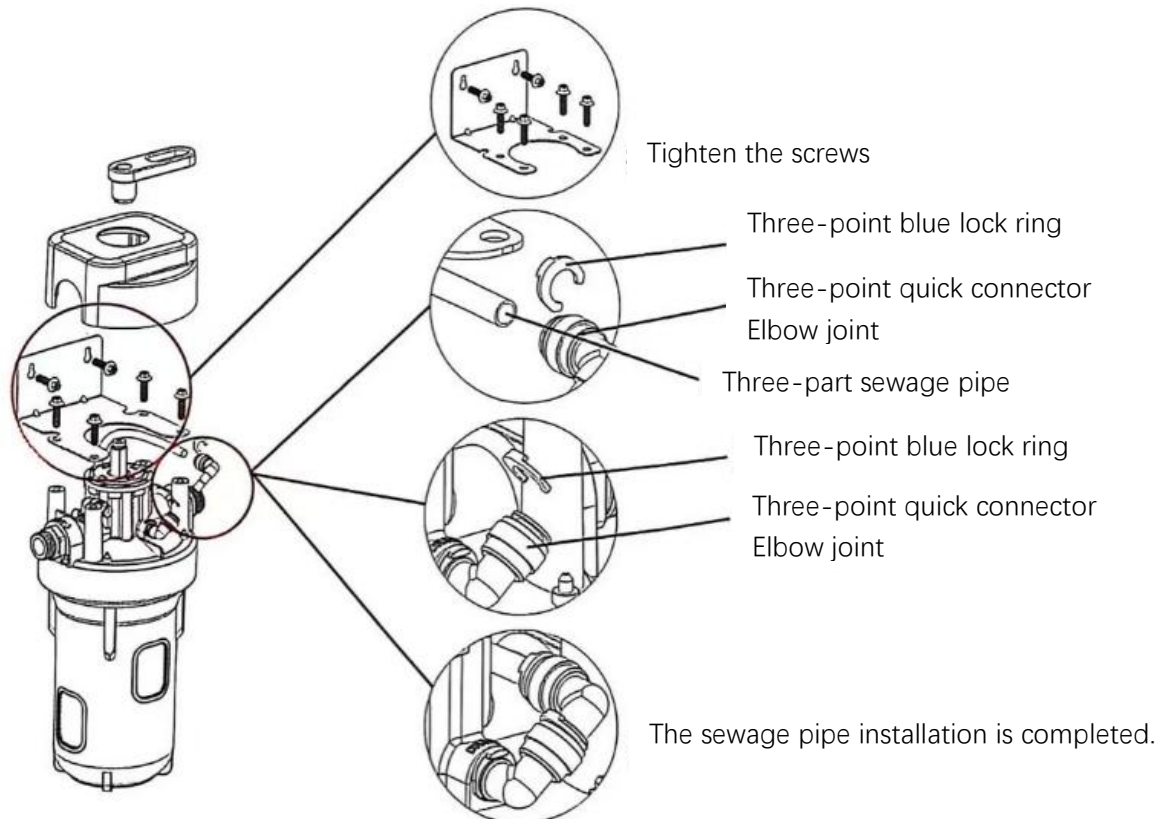

Installation Instructions

5. First, open the top cover and front cover of the pre-filter, then use screws to secure the hanging plate to the filter housing cap. Next, insert the 3-point drain hose into the 3-point quick-connect elbow until it stops, and finally insert the 3-point blue clip.

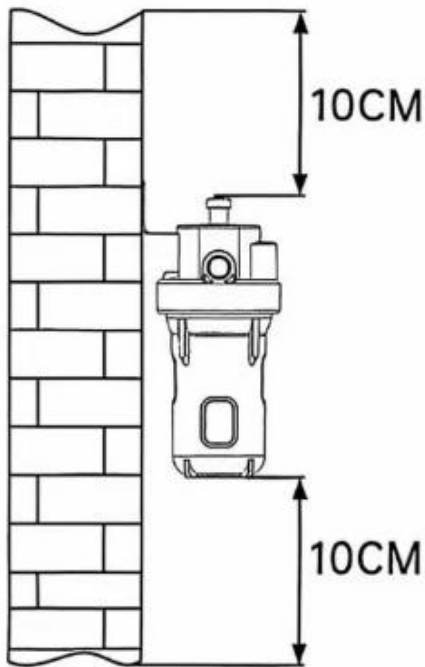

- (1) After completing step 5, use the mounting holes on the hanging plate to mark the installation surface.
- (2) Based on the actual conditions of the installation surface, select self-tapping screws or expansion bolts to secure the hanging plate. The fixing method must be able to support the weight of the pre-filter when filled with water over the long term.
- (3) Drill holes at the marked positions

6. You can remove the viewing window cover on the filter housing to check the condition of the filter cartridge. If exposed to sunlight, cover it with the viewing window cover to prevent algae growth inside the pre-filter caused by direct sunlight.

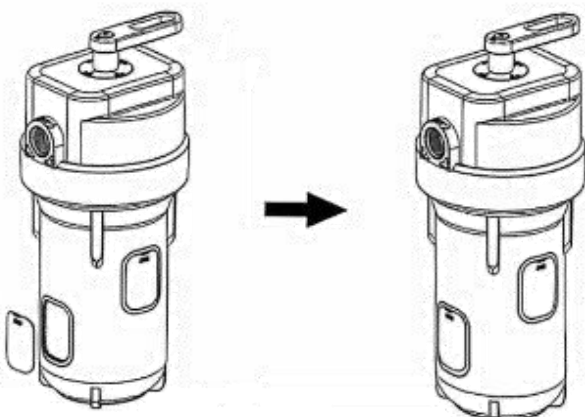

Note: Leave at least 10 cm of space below the filter housing to allow for filter cartridge replacement, and at least 10 cm of space above to allow for operation of the control valve handle.

Installation Instructions

7. You can choose to use the 3-point outlet. Remove the plug, insert the 3-point tube into the 3-point outlet, and the dual outlet function is achieved.

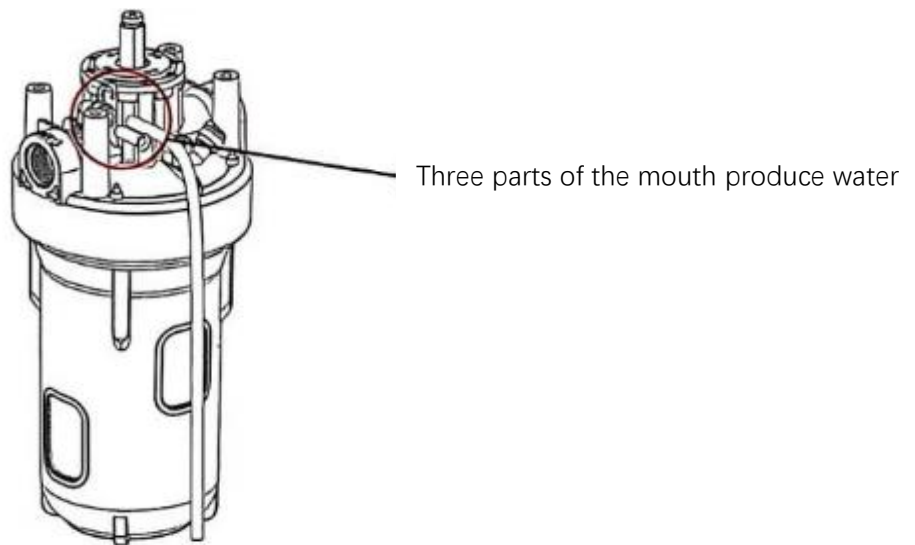

Note: The 3-point tube needs to be purchased separately. The 3-point outlet is plugged with a cap at the factory.

Installation Instructions

4. Overall Installation Diagram

General Diagram of Installation Without Hanging Plates

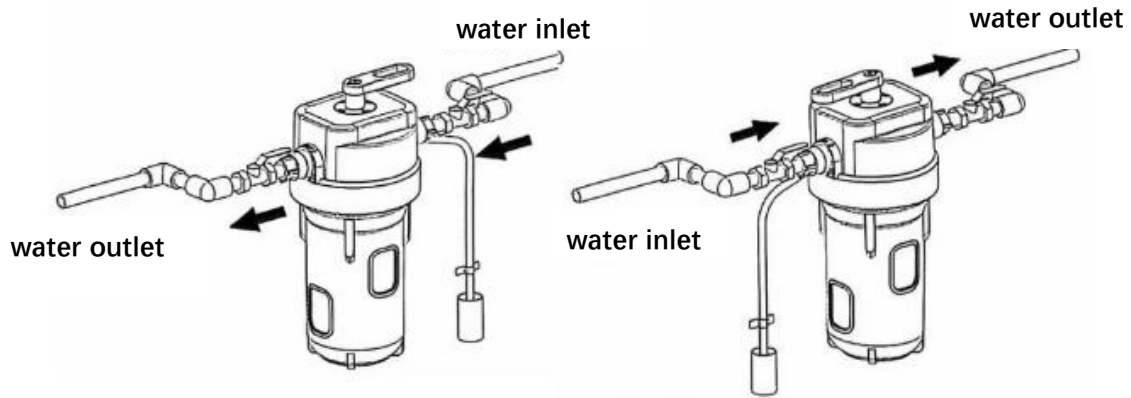

Installation method: right in and left out Left-in and right-out installation method

There is a general diagram for the installation of hanging plates

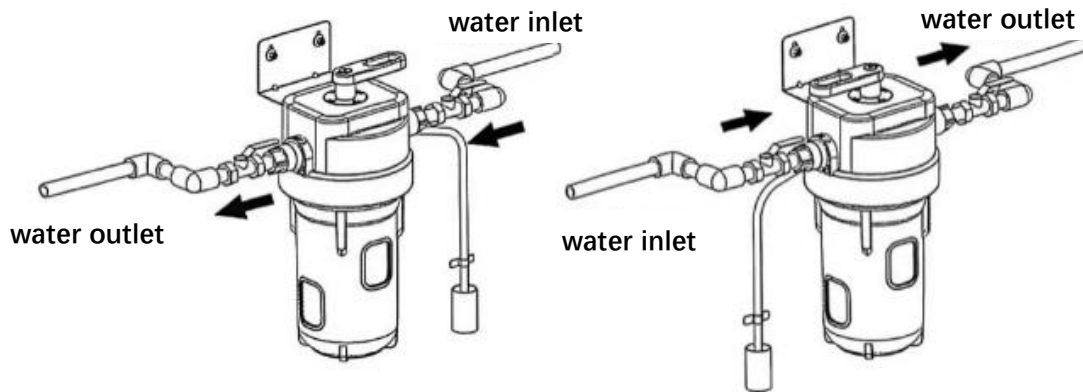

Installation method: right in and left out Left-in and right-out installation method

The positions of the inlet and outlet can be adjusted based on the installation environment, allowing for either a left inlet and right outlet or a right inlet and left outlet configuration.

Installation Instructions

5. Filter Cartridge Replacement

Bypass station

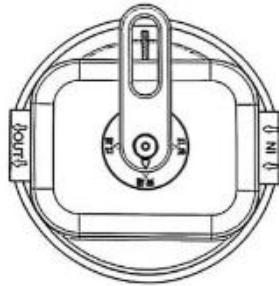

1

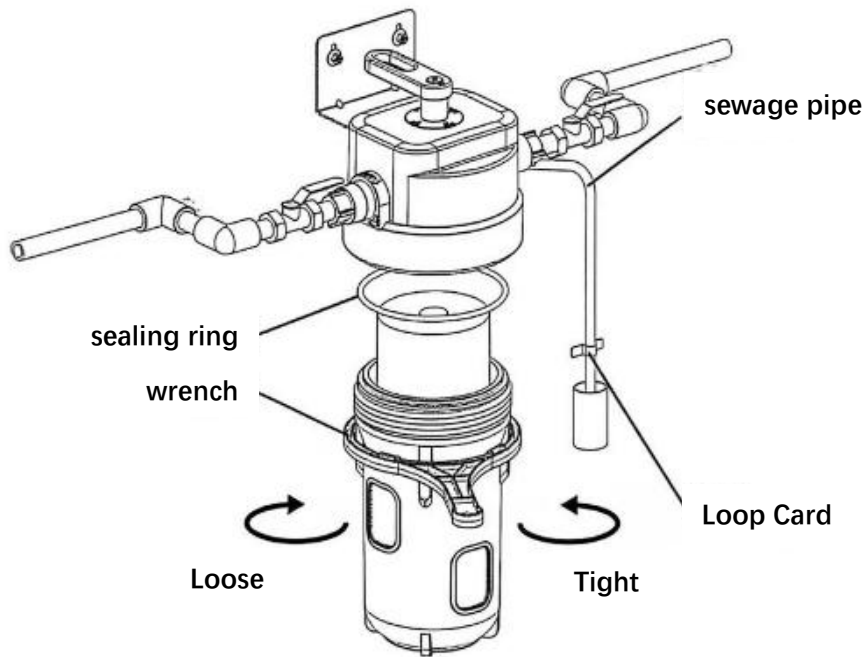

2

Installation Instructions

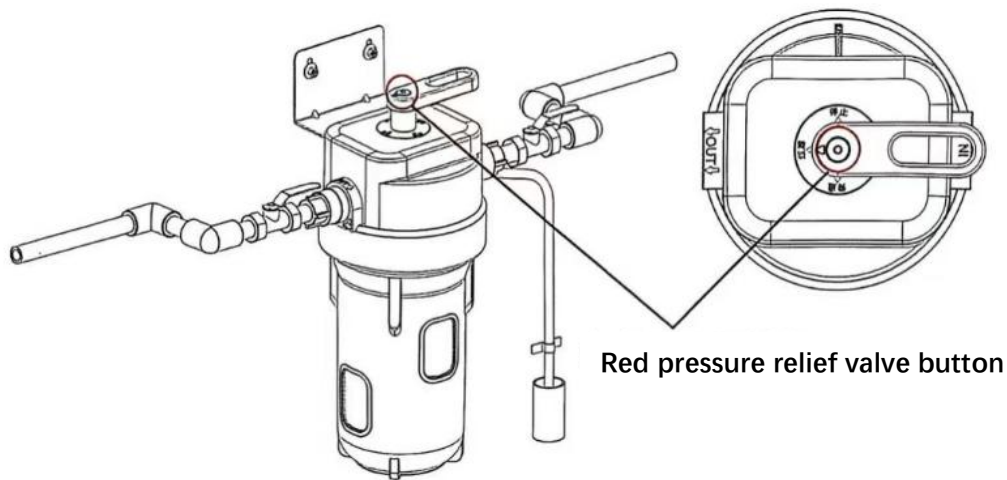

3

- (1) First, use the control valve handle to turn the mode to the bypass position, as shown in Figure 1;
- (2) Use the included filter spanner wrench to loosen the filter housing clockwise and clean it thoroughly, as shown in Figure 2;
- (3) Insert the new filter cartridge into the filter housing. Fit the protrusion on the inner bottom of the filter housing into the center hole of the filter cartridge, and check that the O-ring at the top of the filter housing is correctly positioned;
- (4) Use the included filter spanner wrench to tighten the filter housing and filter housing cap counterclockwise, as shown in Figure 2;
- (5) Slowly turn the mode to the backwash position and allow flushing for 5 minutes to rinse the system before first use;
- (6) Slowly turn the mode to the filtration position, press the red pressure relief button to vent air from the filter housing, as shown in Figure 3;
- (7) Open a faucet and let water run for 2 minutes, then close the faucet and wait 10 minutes. Check all connections and components for leaks or seepage.

Warranty Information

1. Warranty Period

In accordance with national "Three Guarantees" regulations, this product is covered by a one-year warranty for the entire unit.

2. The following situations are not covered under the free warranty. Our company can provide paid services for these cases. Please note:

- (1) Damage caused by improper use, storage, or maintenance by the consumer;
- (2) Damage caused by disassembly or repair by unauthorized service personnel not designated by our company;
- (3) The model on the invoice does not match the model of the product being repaired, or the invoice has been altered;
- (4) No valid invoice is available;
- (5) Damage caused by force majeure;
- (6) Our company shall not be held responsible for quality issues arising from the use of non-original parts;
- (7) If this product is used for non-household purposes, the warranty period for the entire unit will be six months;
- (8) Failures caused by human factors or improper use are not covered under the warranty;
- (9) Please follow the instructions in this manual for correct installation and use;
- (10) Failures or damage caused by using the product under conditions beyond the normal scope of use are not covered under the warranty.